

PARTS LIST			
ITEM	QTY	PART NUMBER	DESCRIPTION
1	1	2B011058G34	HOUSING, ELBOW 15KV 200A SIZE 4
2	1	PSPA00BSCW1914	WIRE, BARE, SOLID COPPER, AWR 14
3	1	255411	TERMINAL, #12-#10 WIRE, SLEEVE
4	1	2X002088G15	PROBE KIT, 15KV LOADBREAK
5	1	2A011001G73	CONNECTOR, #2 BI-METAL
6	1	* PSB2740054001	LABEL, THERMAL TRANSFER
7	1	* 003	LABEL, 1" X 2-5/8"
8	1	* 2A019001P26	CARTON, 20 1/4 X 13 1/4 X 13 3/4 PRINTED
9	1	* IS200LE	INSTRUCTIONS, 200 LOADBREAK ELBOW
10	1	* IS200LUGB	CRIMP CHART, 200A CU-TOP LUG

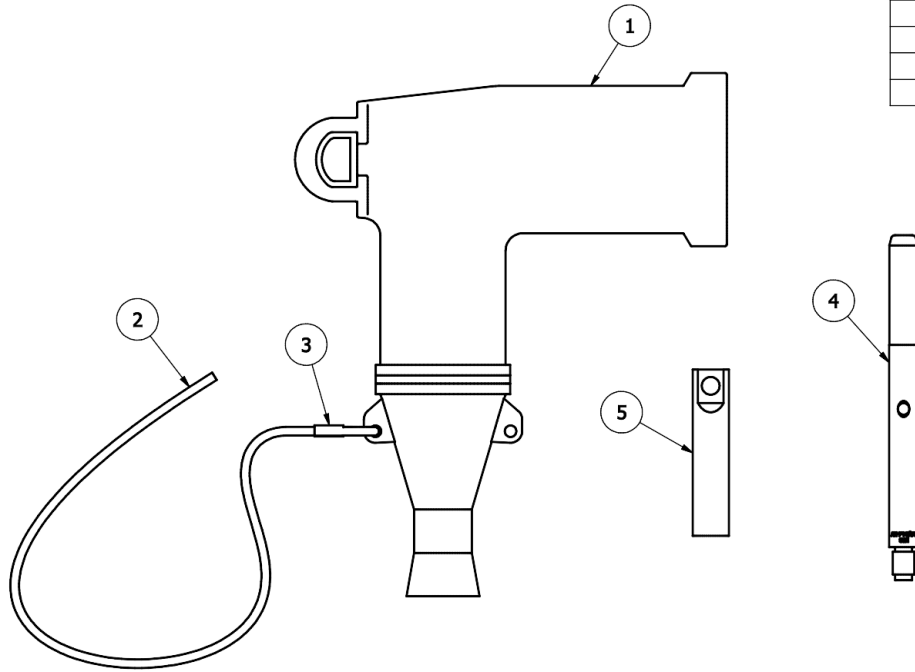

NOTES:

- 1. PARTS LISTED WITH A \* ARE NOT SHOWN ON DWG.

**CF** THIS SYMBOL IDENTIFIES CRITICAL FEATURES

220119016166	01/26/2022	BvB	BvB	TOLERANCE CHART 0.0 = ±0.10 0.00 = ±0.030 0.000 = ±0.015 ANGLE = ±30°	HUBBELL POWER SYSTEMS, Inc.			
EC #	DATE	CHG BY	RESP ENG			TITLE 15KV SIZE 4 LOADBREAK ELBOW W\ AWG14 BARE SOLID COPPER WIRE		
DESC OF DWG: MOVED WIRE - - REASON(S) FOR CHANGE: - DISPOSITION OF MATL: -				CONTENTS ARE CONFIDENTIAL AND THE EXCLUSIVE PROPERTY OF HUBBELL POWER SYSTEMS. NO PUBLICATION, DISTRIBUTION OR COPIES MAY BE MADE WITHOUT THE WRITTEN CONSENT OF HUBBELL POWER SYSTEMS. HUBBELL POWER SYSTEMS UNPUBLISHED ALL RIGHTS RESERVED UNDER THE COPYRIGHT LAWS.	SIZE B	DWG NO. -	CAT / PART / ASSY NO. 215LE43N1418	REV 1
				DO NOT SCALE THIS DRAWING	DRN BY BvB	DATE 3/14/19	SHEET 1 OF 1	